



live

HOME ON THE RANGE

Boulder, CO

barrett studio architects
1944 20th street
boulder co 80302
303.449.1141 p
303.449.9320 f
www.barrettstudio.com

Located in South Boulder, with stunning panoramic views of the Flatirons and Hogback, the Home on the Range is a blend of rich craftsmanship, luxurious furnishings, raw & rustic materials, and modern detailing.

The owners desired a flowing, comfortable home for their family that encouraged play, interaction, and genuine living. This is a Colorado ranch house, responsive to the barns & animals, mountains, big sky, intense wind, and rugged dryness...a home for belonging, for living dreams. Seamless transition from landscape to architecture is complimented by both inward contemplative spaces and outward open spaces with views and literal connections to the land. Experienced as a juxtaposition between hard and soft, rectilinear and curvilinear, the fullness of life is expressed with both precision and love.

A chromatically consistent material palette allows dynamic masses and roof planes to speak gently, reinforcing this as a distinctly western home: rusting steel, board-formed concrete, buff sandstone, weathered reclaimed snow fence, and soft douglas fir all find their places here.



A cluster of distinct building and roof forms are organized along three thick mass walls, one of which moves through the main kitchen and living space, another that links the guesthouse to the main residence, and the third anchoring the studio.

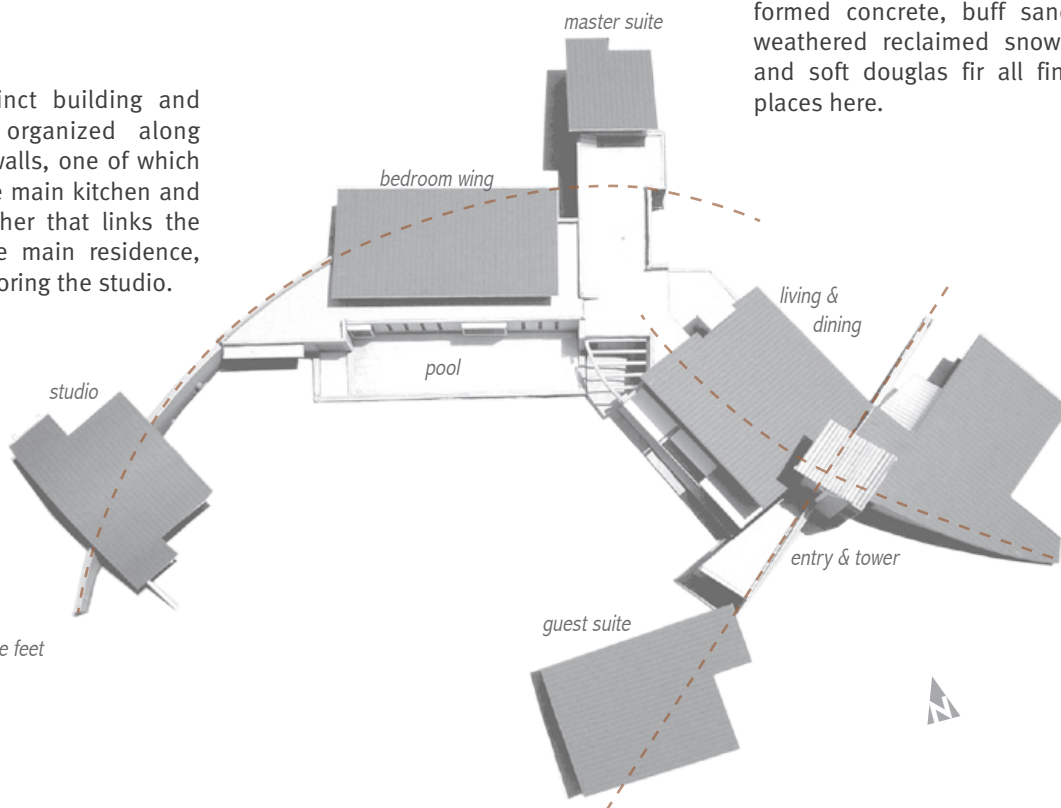

Main House: 5140 square feet
Guest: 1080 square feet
Studio: 760 square feet



structure

Soils and Foundation: The building site's highly expansive soils and immediate adjacency to a subsided coal mine lead to the house's support system of 107 caissons with 48 caissons supporting the pool/spa.
Concrete Walls: Board-form architectural concrete
Timber Frame: Standing dead beetle kill Douglas fir from Oregon
Engineered Lumber: No solid wood framing throughout.

Stone Veneer: Sourced from the Arkansas Valley with splash of site-sourced rock.
Siding: Reclaimed Wyoming wind fencing and weathering steel (cor-ten)
Roofing: Standing seam weathering steel (cor-ten)
Ceiling & Soffits: Clear vertical grain Douglas fir
Flooring: Wood: Reclaimed white oak from Wisconsin log cabin, finished with Bona Traffic waterborne floor finish; Cork Tiles finished with Osmo hard wax oil.
Wood Interior Walls: Douglas fir finished with Osmo hard wax oil.
Casework Finish: Osmo hard wax oil.
Doors: White Oak

materials

Drywall & Paint: Level 5 finish with Benjamin Moore Natura zero VOC paint
Cabinets: White oak veneer & Douglas fir veneer
Countertops Kitchen: Concrete, cast and finished off-site
Guest Bath & Entry Stone Tiles: Locally Quarried Colorado Buff Sandstone with level 1 honed finish.
Master Bath Stone Slab & Tile: Waterworks Brazilian Limestone: Lagos Azul
Girls' Baths Stone Slab & Tile: Waterworks Italian Limestone: Avana
Spiral Stairs: Steel with custom patina and reclaimed white oak treads

systems

Passive Solar: Majority of glazing is south facing and shaded in summer. Interior has high level of thermal mass for solar heat storage. Ducted return air through solar mass (concrete walls in living room) distributes passively heated air through the house.
Solar Photovoltaic Array: 21.4 Kilowatt grid-tied array powers lights, appliances, and geothermal pumps.
Solar Thermal: Viessman evacuated tubes provide 95% of domestic hot water.
Geothermal Field: 12 vertical holes drilled 150 feet deep connected to heat pumps provide hot or cold air as needed seasonally. This system is approximately four times as efficient as a natural gas furnace.
Heat Recovery Ventilator: Provides preheated fresh air to house using heat from stale exhaust air.
Living Room Fire Place: High thermal mass EPA compliant masonry heater.
Pool: 31,000 gallons of water heated with 75,000 BTU natural gas fired boiler.

landscape

Stone Pavers & Slabs: Locally Quarried Colorado Buff Sandstone.
Site Walls: Weathering Steel (cor-ten)
Sculptural Stones: Sourced from windswept Wyoming wind farms
Trees: West Courtyard – 3 trained Pinus Sylvestris Front – 5 Pinus Ponderosa Meditation Garden – 2 'Kosterii' Spruce & 2 Pinus 'Verdidise Globosa' Front of Curved Studio - Ginkgo Bilboa (planet's most ancient tree)
Plantings: veronica lewanenansis, thyme varieties, Artemisia varieties, sedum varieties, lavender, yucca, mixed native perennials

team

Architecture & Interiors:

Barrett Studio architects
www.barrettstudio.com

Structural Engineering:

KL&A, Inc.
www.klaa.com

Builder:

Harrington Homes, Inc.
www.harringtonhomesboulder.com

Lighting:

Element Architectural Lighting Design

Landscape:

Marpa Design Studio
www.marpa.com

